

Step 1. Measure the width of your door. Make sure you include any brick mould or sidelight extensions to this measurement. This will be your “D” measurement. (See Drawing A1- A4)

Step 2. Choose the style and width of the pilaster you would like to use. This will be your “A” measure (since you are using 2 pilasters you must double the measurement). The height of the pilaster will run to the top of

your door including any brick mould and/or transom. Pilasters can be cut to your specific height by cutting from the bottom of the pilaster. Some of our pilasters are offered with a loose plinth block.

Step 3. Add the width of your door (“D dimension) and the width of your pilasters (“A” dimension) to determine the “B” dimension or the bottom width of the combination pediment.

Example:	40”	+	14”	=	54”
	“D” dimension		“A” dimension		“B” dimension
	(36” door + 4” brickmould)		(Pilasters - 7” + 7”)		

Step 4. Select a Crosshead or Combination Pediment, from the selected crosshead or combination pediment chart, equal or greater than the “B” dimension that you have calculated. You can choose a Crosshead or Combination Pediment measuring up to 1-1/2” larger

than your “B” dimension. **Important - Do not choose a size smaller than your “B” dimension.** The item number listed across from your selected “B” dimension will be the number you will order.

ENTRANCE CROSS-SECTION “WHERE TO MEASURE”

BRICK MOLDING W/MASONRY/EXT. DOOR

A1

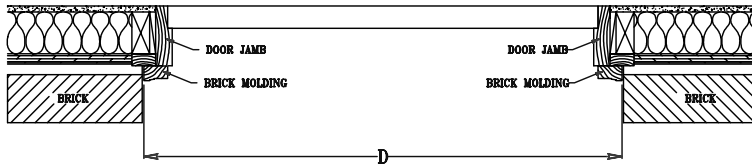

BRICK MOLDING W/SIDING/EXT. DOOR

A2

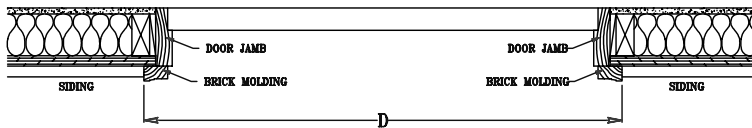

JAMB TO JAMB W/SIDELIGHTS/EXT. DOOR

A3

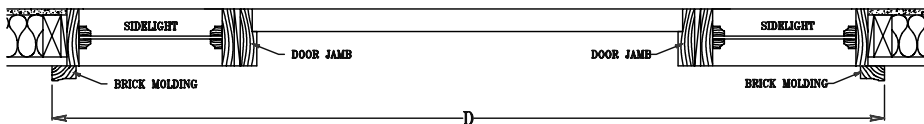

JAMB TO JAMB/EXT. DOOR

A4

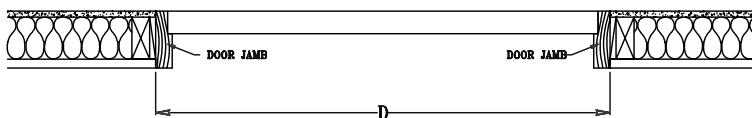

ENTRANCE COMPONENT MEASUREMENT

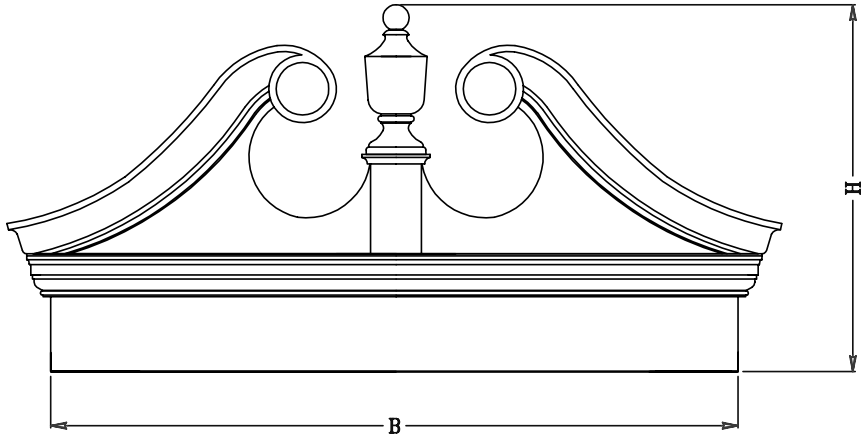
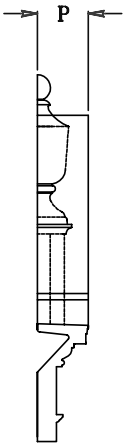

COMBINATION
PEDIMENT

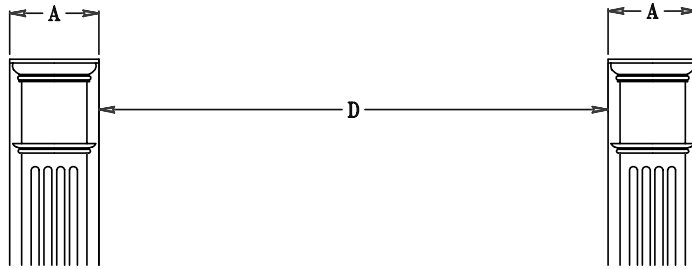
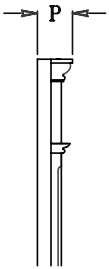

ONE PIECE CROSSHEAD AND PEDIMENT

